

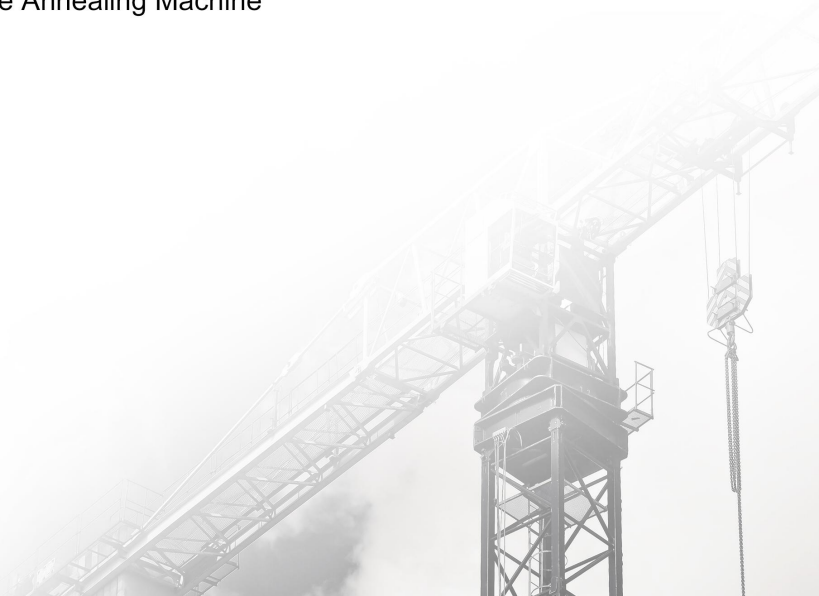

Rigging Equipments

- Wire Rope Swaging Dies
- Hydraulic Wire Rope Swaging Machine
- Tension Testing Bed
- Turntable
- Splicing Pin
- Wire Rope Splicing Machine
- Wire Rope Annealing Machine



Wire Rope Swaging Dies

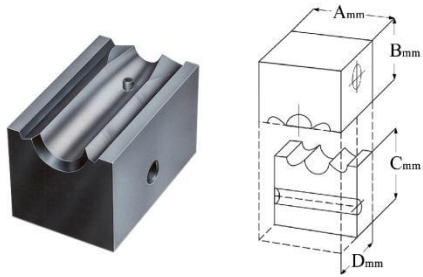

First of all, please provide the sizes as marked A, B, C, D in the picture.

Secondly, choose the right way you use to fix the dies on your machine. There are some ways for your reference.

① Bolt Hole

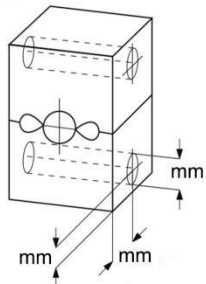

② Blind Hole

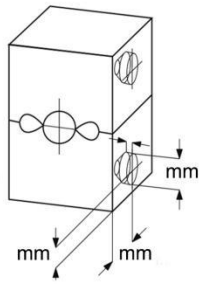

③ Slot

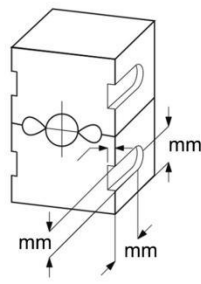

Swaging Dies Workshop



The Comparison Table of Swage Dies and Aluminum Ferrule

Aluminum Ferrule	The Size of Swage Dies	(FC) mm (0.4-0.5) Fill Factor	(IWR) mm (0.5-0.6) Fill Factor	After Pressing		Pressure (KN)
				(mm)	Tolerance (mm)	
1	1	0.9-1.1	0.8-1.0	3		5
1.5	1.5	1.2-1.6	1.1-1.4	3.8		10
2	2	1.7-2.1	1.5-1.9	4	+0.1	20
2.5	2.5	2.2-2.6	2.0-2.4	5		30
3	3	2.7-3.2	2.5-2.9	6		45
3.5	3.5	3.3-3.7	3.0-3.4	7	+0.15	60
4	4	3.8-4.2	3.5-3.8	8		80
4.5	4.5	4.3-4.7	3.9-4.3	9		100
5	5	4.8-5.3	4.4-4.8	10		125
6	6	5.4-6.3	4.9-5.8	12		180
6.5	6.5	6.4-6.8	5.9-6.2	13		210
7	7	6.9-7.4	6.3-6.7	14		250
8	8	7.5-8.4	6.8-7.7	16		320
9	9	8.5-9.5	7.8-8.6	18	+0.3	410
10	10	9.6-10.5	8.7-9.6	20		500
11	11	10.6-11.6	9.7-10.5	22		600
12	12	11.7-12.6	10.6-11.5	24	+0.4	720
13	13	12.7-13.7	11.6-12.5	26		850
14	14	13.8-14.7	12.6-13.4	28		1000
16	16	14.8-16.8	13.5-15.3	32	+0.5	1300
18	18	16.9-18.9	15.4-17.3	36		1600
20	20	19.0-21.0	17.4-19.2	40	+0.6	2000
22	22	21.1-23.1	19.3-21.1	44		2400
24	24	23.2-25.2	21.2-23.0	48		2900
26	26	25.3-27.3	23.1-24.9	52		3400
28	28	27.4-29.4	25.0-26.8	56	+0.8	3900
30	30	29.5-31.5	26.9-28.8	60		4500
32	32	31.6-33.6	28.9-30.7	64	+1	5100
34	34	33.7-35.7	30.8-32.6	68		5800
36	36	35.8-37.8	32.7-34.5	72		6500

38	38	37.9-39.9	34.6-36.4	76	+1.1	7200
40	40	40.0-42.0	36.5-38.3	80		8000
42	42	42.1-44.1	38.4-40.3	84		8800
44	44	44.2-46.2	40.4-42.2	88		9700
46	46	46.3-48.3	42.3-44.1	92	+1.3	10600
48	48	48.0-50.4	44.0-46.2	96		11500
50	50	48.4-52.5	44.2-47.9	100	+1.6	12500
52	52	52.0-54.6	46.3-47.9	104		13500
54	54	52.6-56.7	48.0-51.7	108		14600
56	56	56.0-58.8	50.5-51.9	112		15700
58	58	56.8-60.9	51.8-55.6	116	+1.7	16800
60	60	60.6-63.0	54.7-55.9	120		18000
62	62	61.0-65.1	55.7-59.4	124	+1.8	19200
66	66	65.2-69.3	69.5-63.2	132		22000
70	70	69.4-73.5	63.3-67.1	140		24500
74	74	73.6-77.7	67.2-70.9	148		27000
78	78	77.8-81.9	71.0-74.7	156	+2	30000
82	82	82.0-86.1	74.8-78.6	164		34000
86	86	85.1-90.3	77.7-82.4	172	+2.2	37000
94	94	93.7-98.7	82.5-90.2	188		44200
116	116	113.4-121.8	105.5-111.1	232		67000
126	126	121.9-132.3	111.1-120.7	252	+2.6	79000

Q Type Wire Rope Swaging Machine



Our company has nearly 8 years of experience in the production of wire rope swaging machine. The available swaging machine range from 150 tons to 3000 tons, and can suppress steel wire rope slings with a nominal diameter of 105mm ferrule and 5" flemish eye sleeve.

Our wire rope swaging machine can press a variety of rigging joints, safe and efficient. We use the most advanced production technology to ensure the highest quality manufacturing process and the highest level of product safety, while also satisfying customers' pursuit of cost-effectiveness.

All functional parts of the equipment will undergo strict quality inspection.

Q Type Wire Rope Swaging Machine			
Machine Model	Capacity	Max. Flemish Eye	Max. Ferrule
K-YL150TQ	1500 kN	5/8"	16
K-YL350TQ	3500 kN	1/8"	30
K-YL500TQ	5000 kN	1-1/4"	36
K-YL800TQ	8000 kN	1-3/4"	42
K-YL1000TQ	10000 kN	2-1/4"	56
K-YL1500TQ	15000 kN	2-3/4"	63
K-YL2000TQ	20000 kN	4"	96
K-YL3000TQ	30000 kN	5"	105

K-LD Tension Testing Bed

- The machine body is welded from high-manganese steel plate, and has the advantages of anti-tensile, anti-vibration, durable and not easily deformed. It is configured with ultrahigh-pressure pump system, ensuring plenty of power to easily complete the experiment.
- It adopts electro-hydraulic servo automatic control technology to automatically control two cylinders' propulsion speed to complete the pull test with simple operations.
- The high-precision load cell, calibrated by a national-level metrology institute, has measurement accuracy better than 1%.
- The tension test is controlled by computer, with simple operation interface and complete functions. The test can be completed by simply operating the mouse for selection. It can display data and corresponded curves in real time.
- The computer will directly finish data acquisition and analysis after the pull test, and then print test report and line chart.
- It can be configured with a high-precision camera to make you easily grasp the whole tension process and capture photos in the process.
- The equipment can complete various forms test, such as static tension test, breaking tension test, displacement test, and fatigue test, etc.
- The machine is applicable to tensile test for various riggings, such as steel wire rope, steel wire rope, hoisting belt, strong ring, and shackle, etc. We can also provide tensile test solutions for profiled parts according to customer needs.

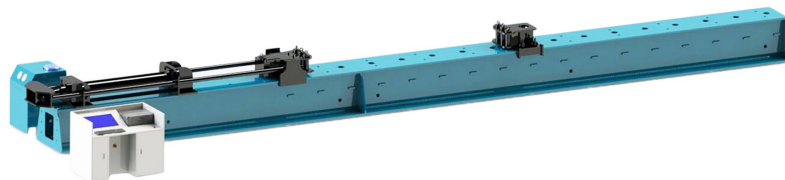

K-LD100 Testing Bed		
Max.Capacity	1000	kN
Cylinder Diameter	φ219	mm
Max.Piston Stroke	1500	mm
Effective Strain Length	7.1+1.5	m
Oil Pressure(High / Low)	40/7	MPa
Rate of Flow	3.8/20	L/min
Power of Motor	4	kW
Power Parameters	380/50 (could be customized)	V/Hz
Overall Diameter(L*W*H)	12200*830*1020	mm
Weight	≈6500	kg
The Located Speed of Piston	1.5	mm/s
The Backward Speed of Piston	12	mm/s
Tolerance of Pull Testing Precision	≤1%	dB
Tolerance of Displacement Precision	≤1%	
Tolerance of Static Loading Precision	≤1%	
Computer Control		√
Examining Report		√
Data Display		√
Test Curve		√
Other Performance	1. Cylinder Stroke Limit Protection Function 2. Working Pressure Overload Protection Function 3. Test Force Value Overload Protection Function 4. Overvoltage/Overcurrent Protection 5. Sensor Seismic Protection Function	

Wire Rope Turntable

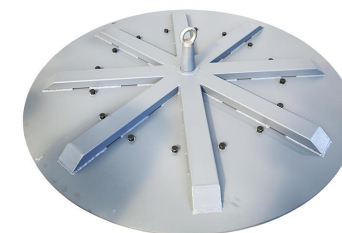
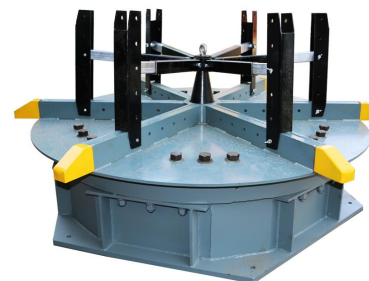

Our turntables include power turntable and manual work turnbuckle. The regular specifications are 3T, 5T, 10T, 20T, 50T(based on carrying capacity). Others also be customized according to customer needs.

Splicing Pin

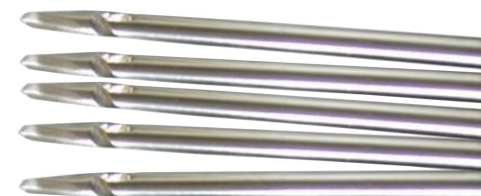

The splicing pin made of high carbon steel is used for wire rope splicing machines. It undergoes multiple process which make it sturdy and waerable.

K32 Wire Rope Splicing Machine

Type	K32
Splice Range	10-32 mm
Height	2200 mm
Length	850 mm
Width	750 mm
Weight	280 kg
Motor Power	3 kW / 3.7 kW
Motor Voltage	50Hz / 380V



K32-C51 Wire Rope Splicing Machine

Type	K-C51 / K-C65
Splice Range	32-51 mm / 32-65 mm
Height	3300 mm
Length	1450 mm
Width	660 mm
Weight	520 kg
Motor Power	4 kW
Motor Voltage	50Hz / 380V



K32-C32 Wire Rope Splicing Machine

Type	K32-C32
Splice Range	10-32 mm
Height	2200 mm
Length	1300 mm
Depth	650 mm
Weight	600 kg
Motor Power	4 kW
Motor Voltage	50Hz / 380V



K-C51/ C65 Wire Rope Splicing Machine

Type	K32-C51
Splice Range	10-51 mm
Height	3100 mm
Length	3100 mm
Width	650 mm
Weight	800 kg
Motor Power	4 kW
Motor Voltage	50Hz / 380V



Wire Rope Annealing Machine

Model	KA-1010
Working Power	220V/50HZ
Rated Power	5KVA
Capacity(Wire rope ϕ)	3mm-16mm
Output setting	Tap position
Weight	75Kg
L×W×H(mm)	700×400×1200
Optional Accessories	Smoke exhaust device



Model	KA-1012
Working Power	380V/50HZ
Rated Power	75KVA
Capacity(Wire rope ϕ)	10mm-40mm
Output setting	Tap position
Weight	450Kg
L×W×H(mm)	1100×1100×1500
Optional Accessories	Smoke exhaust device



Model	KA-1011A
Working Power	380V/50HZ
Rated Power	15KVA
Capacity(Wire rope ϕ)	6mm-32mm
Output setting	Tap position
Weight	280Kg
L×W×H(mm)	750×650×1100
Optional Accessories	Smoke exhaust device



Model	KA-1013
Working Power	380V/50HZ
Rated Power	100KVA
Capacity(Wire rope ϕ)	20mm-60mm
Output setting	Tap position
Weight	600Kg
L×W×H(mm)	1400×1300×1600
Optional Accessories	Smoke exhaust device

